



Type SV

N.Open Manually Reset
Solenoid Valves



N.Açık Elkurmalı Solenoid
Vanalar



The Manually Reset Solenoid Valves is made to guarantee the gas interception for gas dedector, fire control System, etc. Signal. According to PED97/23 EC

Elkurmalı Solenoid vanalar; gaz kaçak dedektörleri, yangın kontrol sistemleri vb. sistemlerden gelen sinyaller doğrultusunda gazı kapatır. PED97/23 CE direktiflerine uygun tasarlanmış ve üretilmiştir.

ÜRÜN AÇIKLAMASI / PRODUCT DESCRIPTION

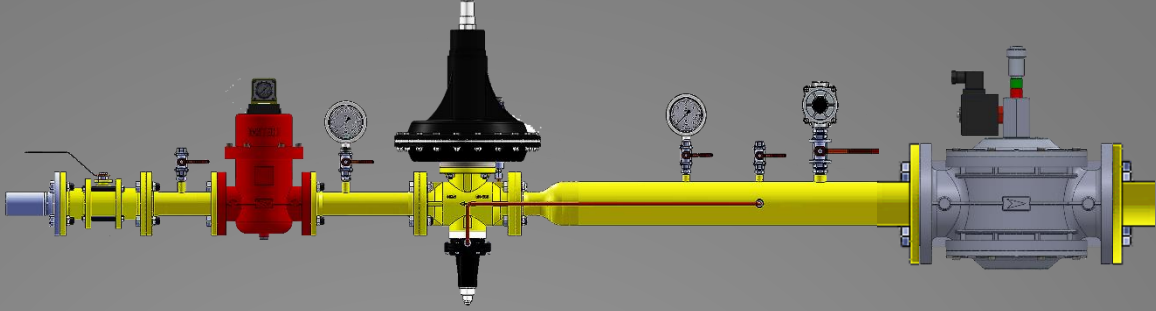

«SV» Serisi Elle Kurmalı Selenoid Vanalar ;

Gaz kaçak alarm sistemi, yangın algılama sistemi veya elektrik sinyali üreten herhangi bir kaynaktan gelen sinyaller doğrultusunda gaz akışını kapat için tasarlanmıştır. Gaz borusuna montajlanır ve alarm sistemi ile irtibatlandırılır. Atmosfere açık ve kapalı alanlarda kullanılabilir. Elektrik sinyali geldiğinde gaz akışı kapanır, tekrar gaz akışını sağlamak için kurma kolunu yukarı kaldırmak gerekir. PED97/23 CE direktiflerine uygun tasarlanmış ve üretilmiştir.

Type "SV" Serie Solenoid valves have been designed to be combined with any gas detection system which sets off a warning signal to shut off the main delivery when an emergency situation is detected. They have been installed at the gas piping and connected with a gas detector. Interrupt the gas flow in a danger situation. The electro-valve is normally located after a filter, upstream of the regulation apparatus and preferably outside the measurement zone. It has been installed with the arrow stamped on the body turned towards the user appliance. To reset the solenoid valve pull the reset knob/handle handle

Suitable for stations in gas transmission, LPG, LNG and CNG facilities.

Gaz Dağıtım istasyonları, LPG, LNG ve CNG uygulamaları için uygundur.



Suitable for gas pressure regulator all small, medium and high capacity boiler plant (Hot water boiler, steam boiler, hot oil heaters, etc...)

Tüm küçük, orta ve yüksek kapasiteli kazan daireleri uygulamaları için uygundur (Sıcak su kazanları, buhar kazanları, kızgın yağ kazanları vb.)



Suitable for process combustion system and all pre-burner gas trains

Proses yakma sistemleri ve tüm yakıcı öncesindeki gaz yolları için uygundur.



Cartridge Filter

ÜRÜN KARAKTERİSTİĞİ / CHARACTERISTIC

Type	SV	SV /6b
Maximum permissible pressure (PS)	500 mbar	6 bar
Nominal Size	from DN15 – DN300 (1/2" – 12")	from DN15 – DN300 (1/2" – 12")
Connections	Flanged to DIN PN16 or ANSI Class 150 RF	
Temperature Range	Operating and ambient temperature -15 °C to +60 °C (Optional -40 °C)	
Materials	Aluminum valve's body and cover; stainless steel springs and control piston; NBR rubber gasket and O-ring; other part are of brass, aluminum and galvanized steel.	
Working Voltage	12 Vdc, 12 V/50 Hz, 24 Vdc, 24 V/50 Hz, 110 V/50-60 Hz, 230 V/50-60 Hz	
Power supply voltage tolerance	-15% ... +10%	
Protection degree	IP65	
Group:	2	
Optional Explosion Proof Coil	Class «F» coil according to the VDE 0580 regulations. Protection Ex II 2G (Eex d IIC T5). Wire insulation Class H (200°C) Electrical insulation IP 67, Certificate of the coil CESI 03 ATEX 212.	
Closing time:	< 1 s	
Power Consumption	Threaded 11 W, DN65 – DN100 28 W, DN125 – DN300 45 W	
CE-mark acc. to PED and PIN-Nr.	CE1783	PED-079
Explosion protection	Mechanical components of regulator do not contain a potential ignition source, thus do not fall in limits of ATEX 95 (94/9/EG). (Used electronic accessories comply with ATEX-demands.)	

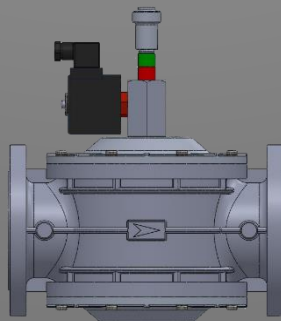

Cartridge Filter

BOYUT VE AĞIRLIKLAR / DIMENSIONS AND WEIGHT

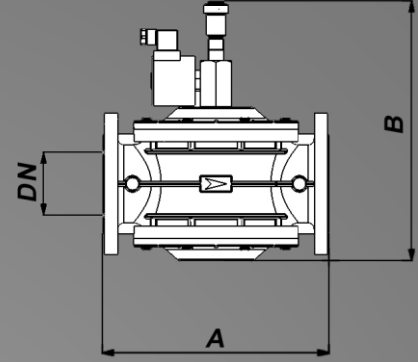
SIZE	DN	Connection	A (mm)	B (mm)	D (mm)
SV 15 C	1/2"	Threaded	64	125	0,5
SV 20 C	3/4"	Threaded	73	128	0,5
SV 25 C	1"	Threaded	86	132	0,7
SV 15	1/2"	Threaded	120	149	1,3
SV 20	3/4"	Threaded	120	149	1,3
SV 25	1"	Threaded	120	149	1,3
SV 32	1 1/4"	Threaded	160	196	2,1
SV 40	1 1/2"	Threaded	160	196	2,1
SV 50	2"	Threaded	160	216	2,4
SV 65	DN65	Flanged	246	415	6,5
SV 80	DN80	Flanged	265	415	6,9
SV 100	DN100	Flanged	350	360	11,6
SV 125	DN125	Flanged	480	455	25,9
SV 150	DN150	Flanged	480	470	27,7
SV 200	DN200	Flanged	600	540	61
SV 250	DN250	Flanged	670	630	87
SV 300	DN300	Flanged	737	760	107

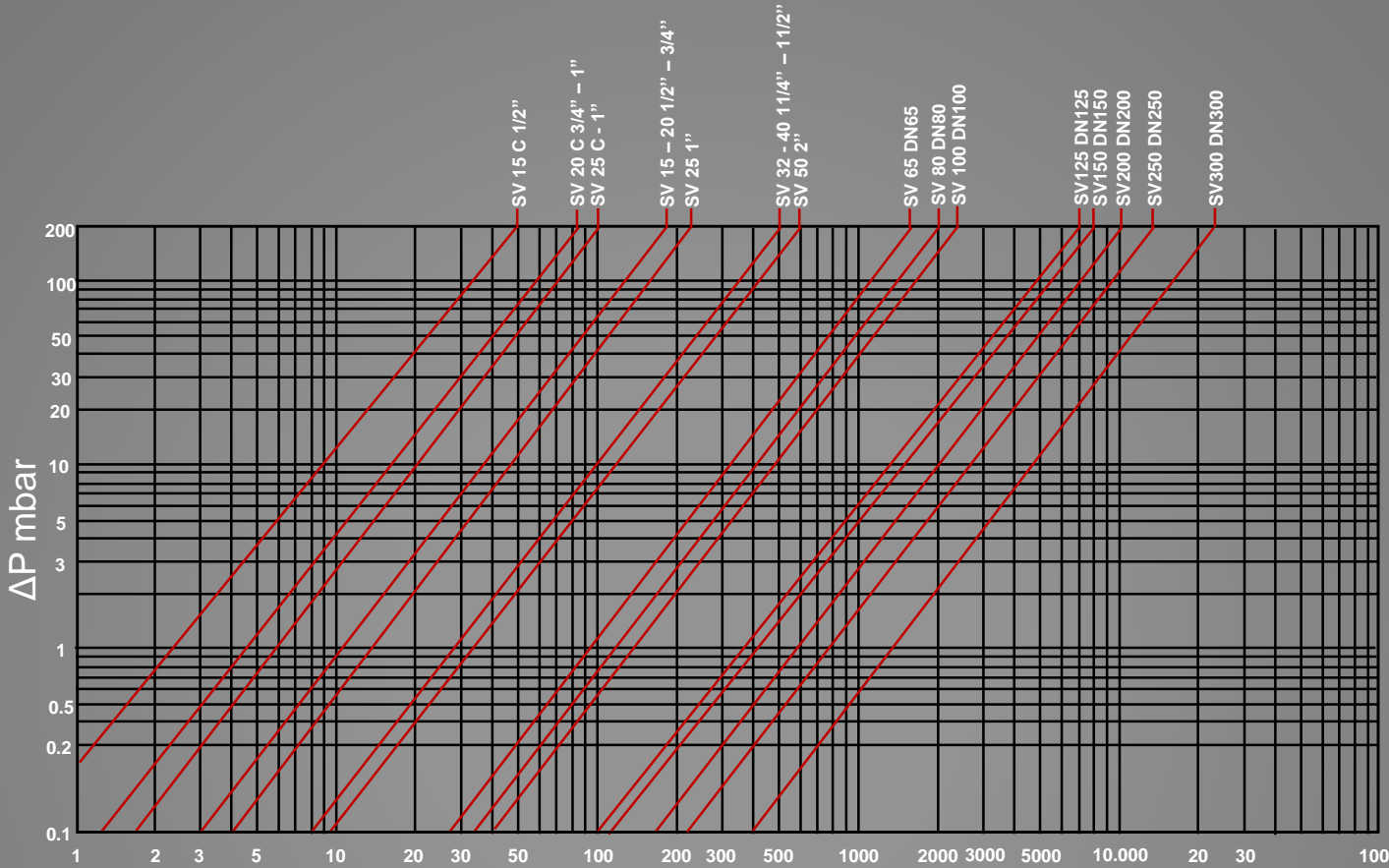

KAPASİTE TABLOSU / CAPACITY TABLE



Debi Q (Stm3/h) / Flow Rate = Doğalgaz / Natural gas, Şartlar, Base: +15°C, 1013 mbar, kuru

Akış ve Diğer Gazlar / Flow with Other Gases

Yandaki tablolarda, akış yoğunluğu 0.61 ve sıcaklık 15 °C Nm³ / h doğal gaz debisini, aşağıdaki formül kullanılarak, diğer gaz akışına dönüştürmek için:

In the tables above, the flow is in (n)m³/h natural gas with a density 0.61 and temperature 15°C. To convert to other gas flow, using the following formula:

$$Q \text{ (Scm/h Naturalgas)} \times F_c = Q \text{ (Scm/h Xgas)}$$

Örnek / Example:

$$Q \text{ (Scm/h Naturalgas)} \times 0.78 = Q \text{ (Scm/h Air)}$$

$$1 \text{ Scm/h Naturalgas} = 0.78 \text{ Scm/h Air}$$

Correction Factor Fc at 15°C

Correction Factor Fc at 15°C	
Propane	0.64
Butane	0.55
Oxygen	0.76
Air	0.78
Nitrogen	0.81
Biogas	0.85
Towngas	1.23
Hydrogen	3.04

SİPARİŞ BİLGİLERİ / ORDERING DATA

SV / 25 / 5 / 16 / 15 / EX

TYPE	type	size	maximum working pressure	flanged desing	Working Voltage	Coil Type
SV						
SIZE						
DN15 C		15				
DN20 C		20				
DN25 C		25				
DN15		15				
DN20		20				
DN 25		25				
DN 32		32				
DN 40		40				
DN 50		50				
DN 65		65				
DN 80		80				
DN 100		100				
DN 125		125				
DN 150		150				
DN 200		200				
DN 250		250				
DN 300		300				
MAXIMUM WORKING PRESSURE						
500 mbar			5			
6 bar			6			
FLANGED DESING						
PN 16				16		
ANSI 150				150		
WORKING VOLTAGE						
10					12 Vdc	
11					12 V/50 Hz	
12					24 Vdc	
13					24 V/50 Hz	
14					110 V/50-60 Hz	
15					230 V/50-60 Hz	
COIL TYPE						
Standard Coil						-
Ex-Proof Coil (Ex II 2G (Eex d IIC T5)						EX

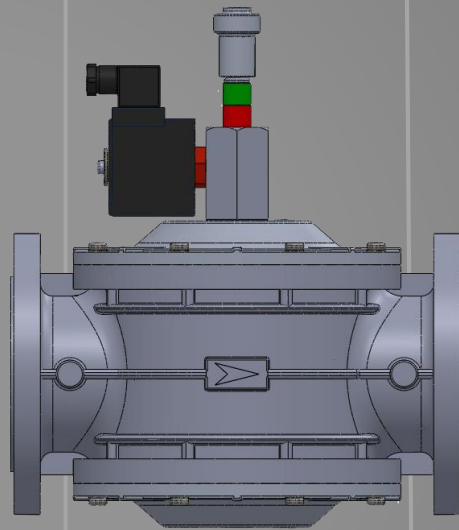

POSTER

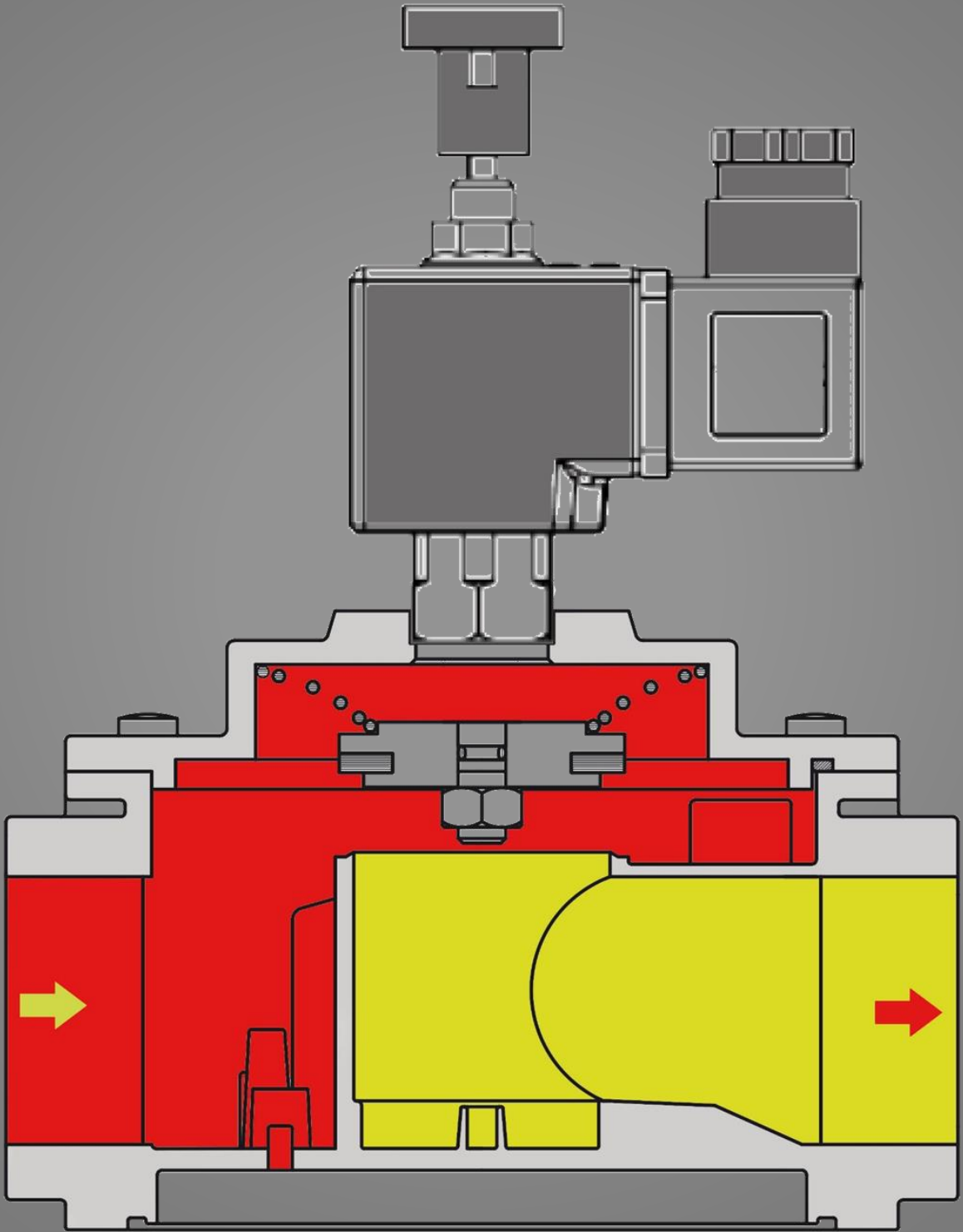

 Inlet

 Outlet

Cartridge Filter